

.100" (2.54mm) Female Header Dual Entry Type Single Row 02 to 40 Contacts Dual Beam Folded Contacts



2801-NBS Series
2801-NB1 Series
2801-NB2 Series

FEATURES:

- . 2-40 Circuits
- . PBT + 30% Glass Fiber [UL 94V-0]
- . Dual entry low profile 5mm height
- . Designed for parallel and vertical board stacking
- . Dual-beam folded contact and low insertion force
- . Standoffs facilitate post soldering clean
- . Mates with .100" grid male headers:
- Single row, right angle and straight headers:
- .025" square and round wire pins

SPECIFICATIONS:

UNIT: INCH
MM

- . Current rating: 3A AC, DC
- . Voltage rating: 250V AC, Maximum
- . Temperature range: -40°C ~ +105°C
- . Contact resistance: Initial Value/10mΩ max.
After environmental testing /20mΩ max.
- . Insulation resistance: 5000 MΩ min
- . Withstand Voltage: 500V AC/minute
- . Applicable PC board thickness: .063"[1.6mm]

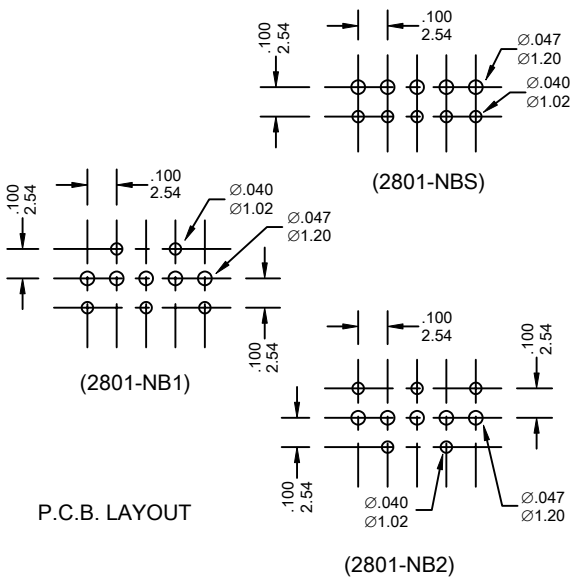
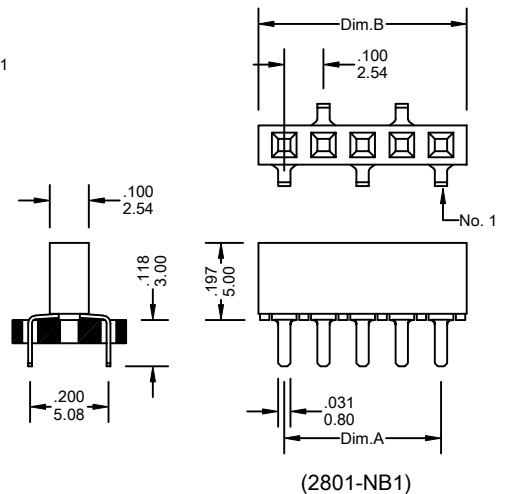
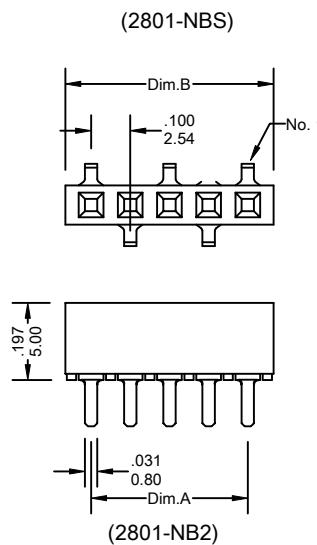
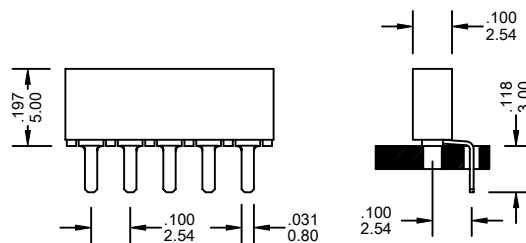
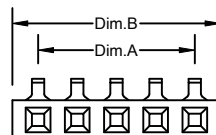

Ordering Information 2801-NBS,NB1,NB2 Series

Series No.	Pitch Type	No. of Contacts	Contact Type	Contact Plating	
2801-N	BS	- 05P	S	G1	- PB
2801-N Series	BS: One side B1: Double side B2: Double side	02 ~ 40P	S: Straight	T: Tin S1: Gold Flash S5: 5u" Gold S10: 10u" Gold S15: 15u" Gold S30: 30u" Gold [G: Full Gold] [S: Selective Gold]	RoHs

Dimensional Information

Circuits	Dim.A± .008 0.20	Dim.B± .008 0.20	Circuits	Dim.A± .008 0.20	Dim.B± .008 0.20	Circuits	Dim.A± .008 0.20	Dim.B± .008 0.20
2	.100 2.54	.220 5.58	3	.200 5.08	.320 8.12	4	.300 7.62	.420 10.66

* FOR CIRCUIT SIZES 5 THROUGH 40 ADD .100" OR 2.54MM FOR EACH ADDITIONAL PIN.